Main Stage Technical Specification

The Peoples Theatre Main Stage presents a proscenium arch stage.

(proscenium at mid-stage – see diagram)

A 480 seat raked auditorium. (+ 5 seat wheelchair bay)

Main Stage Floor Dimensions

15m full stage depth from curved, back-wall Cyc to front apron.

10m from Cyc to mid-stage proscenium arch (“up-stage”)

5m from mid-stage proscenium arch to thrust apron (“fore-stage”)

10.3m width at mid-stage proscenium arch.

Widens to 12m width at down-stage ‘wing’ apron.

3.6m forestage depth from pros arch to down-stage ‘wing’ apron.

1.4m forestage depth from down-stage ‘wing’ apron-line to down-stage central thrust.

Central thrust approx. 8m width

Proscenium arch height generally placed at 5m height.

Stage height from auditorium floor 0.75m

(treads from apron wings to auditorium floor for access available)

Large scene dock, set-prep and temporary storage directly into props area leading into ST/L wings.

Main Stage Technical Specification

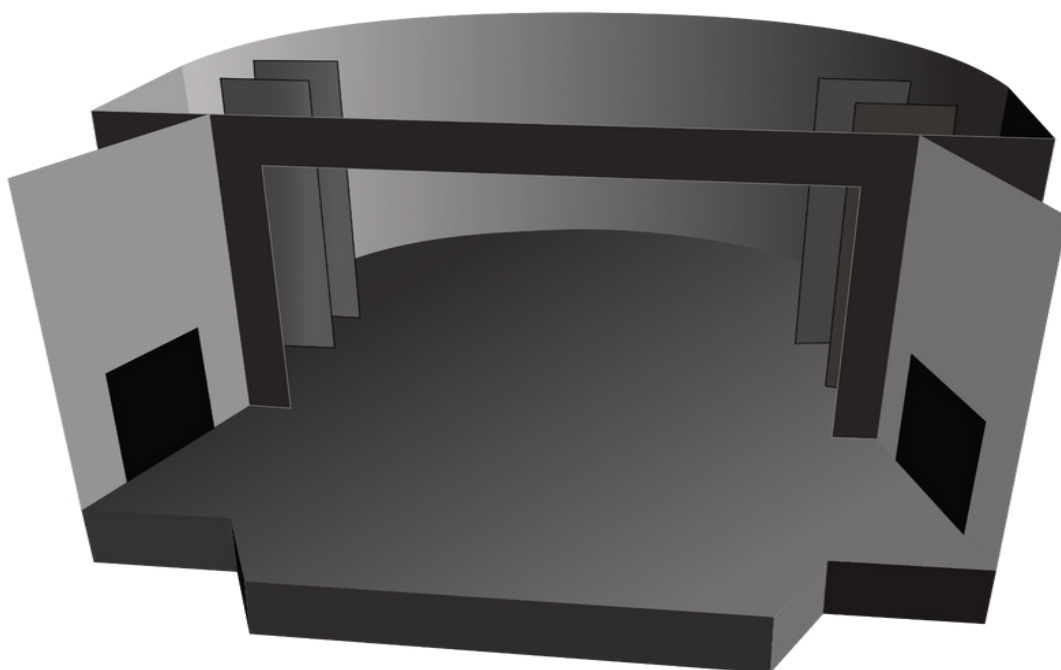
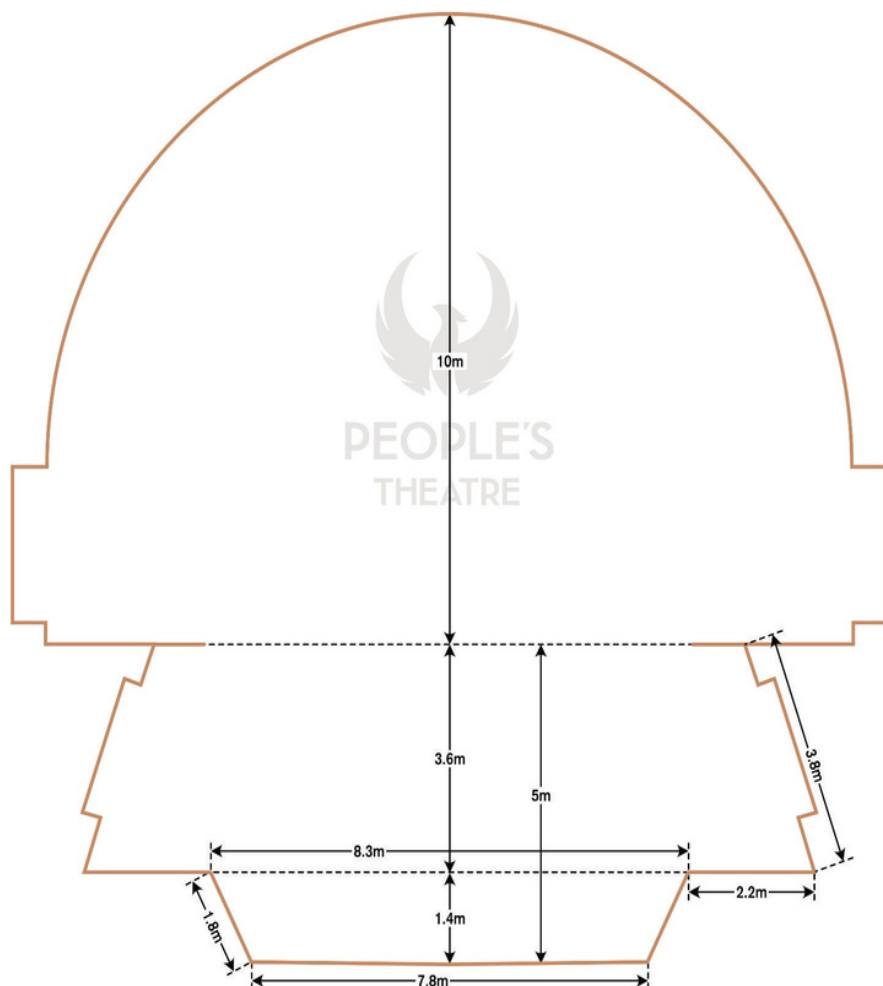

Main Stage Technical Specification

Main Stage Provision

The main stage floor surface is skimmed with black painted ply.

Fixed 'dead hung' serge leg wing-masking and fixed 'dead hung' flown headers.

Fixed 'dead hung' black Tabs on full stage-width track, 4m up-stage from proscenium arch (hand-winch ST/R).

Fixed 'dead hung' Red Tabs at proscenium arch (hand-winch ST/R).

4 Track Bars (powered (drill) winches to raise / lower from St/L wing. (cloth/scenic element 'wipe' facility)

3 'Hemp' lines hand-hauled bars from St/L wing.

Tracks / Hemps evenly spaced upstage to Cyc.

Main Stage Technical Specification

On-Stage Overhead Lighting

**4 L.X I.W.B. bars flown on ladder truss. ...10 x 15a circuits on each.
(powered (drill) winches to raise/lower from St/L wing for rigging)**

Each bar mwbl 200kg

32a + 16a + 13a break-outs at stage floor level ST/R.

LX1 positioned 1m upstage of Pros arch.

LX2 positioned 2m upstage of LX1

LX3 positioned 3m upstage of LX2

LX4 positioned (Cyc Ba)r 2m upstage of LX3

Mobile/temporary access to height on-stage via Tallescope.

S.M. desk at ST/R. (audio stage relay / visual stage monitor / comms to tech / dressing rooms / announcement P.A)

Performers entrance/exit upstage of proscenium arch at ST/L/R

Performers entrance/exit downstage of proscenium arch onto forestage via 'boxes' at ST/L/R

Under-stage cross-over corridor/stairs directly from dressing rooms.

2 secure, serviced basement dressing rooms with stairway access to stage. 25 and 15 person capacity respectively.

Main Stage Technical Specification

Overhead Bridges

3 fixed overhead 'bridge walkways' over auditorium for L.X.

Br1 1m from stage apron 6 x 15a circuits

Br2 4m from stage apron 6 x 15a circuits

Br 3 8m from stage apron 8 x 15a circuits

All at approx. 6m height from auditorium floor.

Access to height via 'cat ladder'.

Fixed horizontal bars (perches) to each side of auditorium.
10 circuits on each at approx. 4-6m height from auditorium floor.
Access via wall hatches.

L.X. Stock

On-stage overheads:

Bar 1. 6 x 1k Fresnels + 'pipe end' LED pars.

Bar 2. 6 x 1k Fresnels + 'pipe end' LED Pars

Bar 3. 6 x 1k Fresnels + 'pipe end' LED Pars

Bar 4. 4 x 4cell Cyc Floods

Auditorium overheads:

Br 1 6x Selecon 1k Fresnels

Br 2. 6x 750k Profiles

Br 3. 8x 750k Profiles

Side bars: 3 750k Profiles (on each side) 2 LED Pars + 1
1k fresnel (each side at apron)

Main Stage Technical Specification

Lighting Control

ETC Ion Lighting console (512 DMX / 2 Universe) + extra 'Sub' wing.

96 LD-90 Dimmers. Connectivity thru Socapex to patch bays @ 15amp (6 circuits each)

Lighting 'Op' position at rear auditorium.

Sound

Auditorium P.A.

Martin audio 500w speaker pairs 'flown' at stage apron – at mid auditorium- at rear auditorium.

2 'wedges' available for on-stage monitors.

A small stock of XLR cable is available.

Sound Control

Behringer X32 Digital mixer.

Dual CD player for playback.

Behringer S16 Pre-amp / Drive rack 260

4 x Yamaha 500w Power Amps

Sound 'Op' position at rear auditorium.

Additional Equipment

Additional Sound (e.g. microphones - radio or cable), Lighting or Stage equipment can be provided following further discussion and agreement.

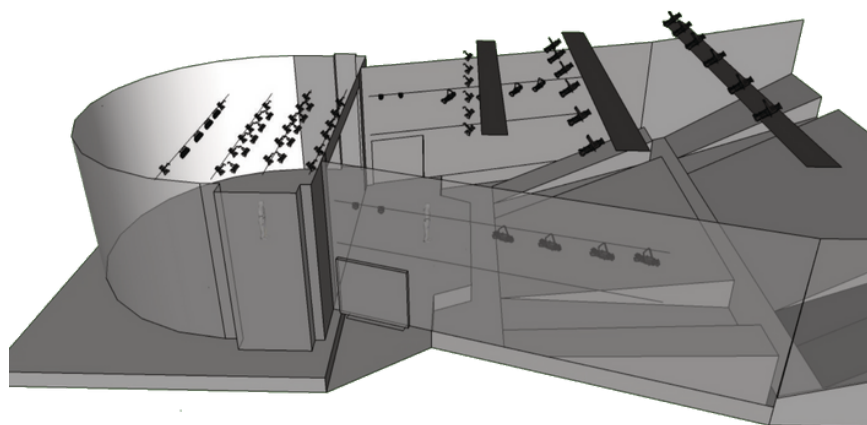

Main Stage Technical Specification

Main Stage Facilities

Public access to the auditorium is via the main theatre entrance leading directly from the venue's ground-floor Main Foyer, Bar and Reception area via corridors either side of the auditorium to front of stage auditorium entrances.

Auditorium rear can also be serviced by staircase from Main Foyer.

Production 'get-in' access is from the rear of the building (two steps up from load-in area (from private car park) through warehouse door into large scene-dock, holding and storage area.

Flat 'roll-in' access from scene-dock leading directly into stage right wing.

Company and Cast entrance is through the private 'Greenroom' side entrance leading to stage, members-bar and social area, facilities and dressing rooms.

There are two rehearsal rooms. (10m x 6m) and (8m x 5m)

There is a large in-house Wardrobe Dept. with limited laundry facilities available.

There is an extensive, well-stocked 'props' dept.

There is a well- equipped workshop, paint shop and 'set' preparation area.

There is limited parking facility around the building and although the building is conveniently situated by a main road from the city centre, (3km), the theatre is situated in a largely residential area so respect needs to be observed regarding local residents.

Local public transport links are good with bus services from outside the building to city centre and surrounding area.